

Self-Contained Ground & Lower Ground Floors 10-13 Lovat Lane, London, EC3



Transport Links

- 0.10 miles from Monument
- 0.60 miles from London Bridge
- 0.50 miles from Tower Hill
- 0.30 miles from Bank

Lease

Available by way of a sublease or assignment to 17th October 2028.

Rent

£42.50 per sq ft (Blended)

Service Charge (2023/2024)

Estimated at £3.34 per sq ft

Accommodation

Part Ground Floor	560 sq ft	52.03 m ²
Part LG Floor	372 sq ft	34.56 m ²
Total	932 sq ft	86.59 m²

Rates Payable (2023/24)

Estimated at £13.95 per sq ft

However, all interested parties should make their own enquiries.

VAT

The building has been elected for VAT

Amenities

- Air conditioning
- Perimeter and underfloor trunking provision
- Meeting room
- Kitchen/breakout
- Suspended ceiling
- Self-Contained with dedicated entrance at Ground Floor
- Located on a pedestrianised street
- Lower Ground and Ground floor units with interconnecting staircase
- Dedicated WC & Shower
- EPC Rating C.

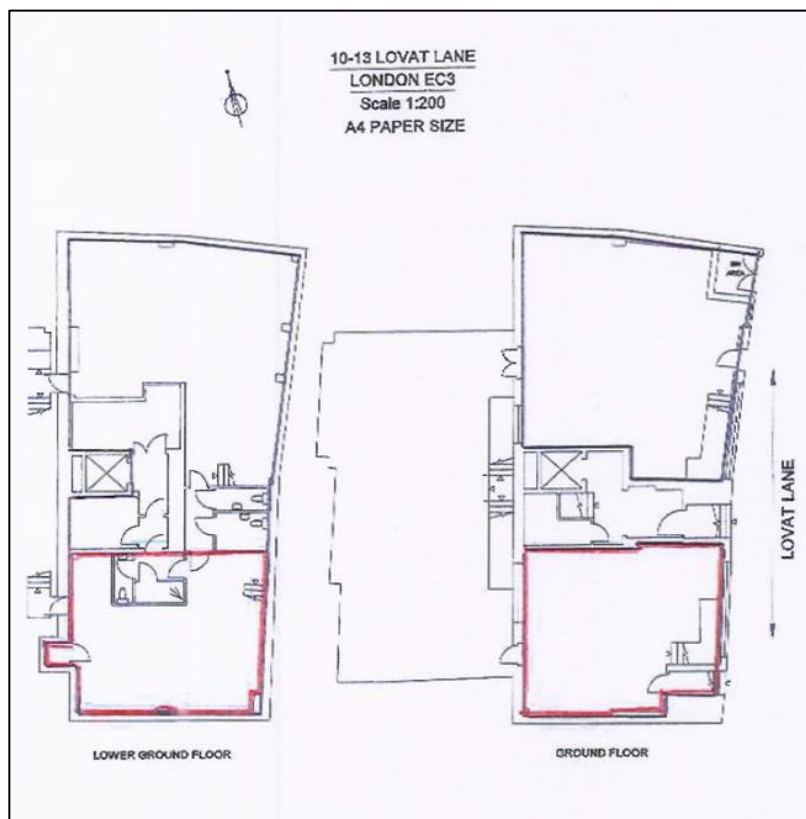
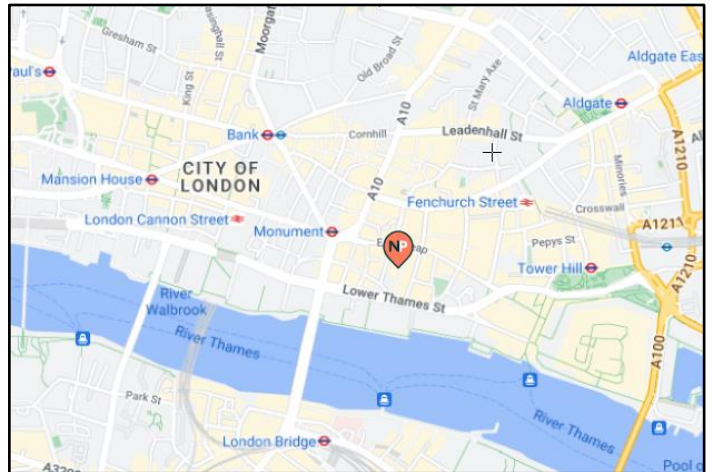

Indicative Floor Plans

Newton Perkins

Nick Russell-Smith – 07918 588 107
E-mail: nrs@newtonperkins.com

Alice Wiley – 07546 695 724
E-mail: aw@newtonperkins.com

Newton Perkins LLP, Peek House, 20 Eastcheap, London EC3M 1NP

Newton Perkins for themselves and for the vendors or lessors of this property whose agents they are given notice that:- (1) The particulars are set out as a general outline for the guidance of the intending purchasers and do not constitute part of an offer or contract; (2) All descriptions, dimensions, references to condition and necessary permissions for use and occupation and other details are given without responsibility and any intending purchasers should not rely on them as standards or representations of fact but must satisfy themselves by inspection or otherwise as to the correctness of each of them; (3) No persons in the employment of Newton Perkins has any authority to make or give any representation or warranty whatsoever in relation to this property